



 **Infinity**<sup>®</sup>

reference series  
5000cs, 6000cs &  
6800cs  
instructions

**Thank you** for purchasing Infinity's Reference Series automotive loudspeaker components. We've organized this manual to make your installation as simple and trouble-free as possible. Please read it thoroughly before proceeding. Remember to keep your sales receipt with this manual in a safe place so both are available for future reference.

**IMPORTANT:** Installation of automotive stereo components can require extensive experience with a variety of mechanical and electrical procedures. Although these instructions explain how to install Reference Series speakers in a general sense, they do not show the exact installation methods for your particular vehicle. If you do not feel you have the experience, do not attempt the installation yourself; instead, ask your authorized Infinity car audio dealer about professional installation options.

**WARNING:** Playing loud music in an automobile can permanently damage your hearing, as well as hinder your ability to hear traffic. The maximum volume levels achievable with Infinity speakers, combined with high power amplification, may exceed safe levels for extended listening. We recommend using low volume levels when driving. Infinity accepts no liability for hearing loss, bodily injury, or property damage as a result of use or misuse of this product.

## INSTALLATION WARNINGS AND TIPS

- Always wear protective eyewear when using any tools.
- Turn off all audio systems and other electrical devices before you start. Disconnect the (-) negative lead from your vehicle's battery.
- Keep speakers in their package until final installation. When moving a speaker, always rest it with the cone or dome facing up. Never use force to install any speaker.
- Check clearances on both sides of a planned mounting surface before drilling any holes or installing any screws. Remember that the screws can extend behind the surface.
- At the installation sites, locate and make a note of all fuel lines, hydraulic brake lines, vacuum lines, and electrical wiring. Use extreme caution when cutting or drilling in and around these areas.

**CAUTION:** In some cars, fuel tanks may be located directly beneath the rear deck. Check for adequate speaker basket clearance before considering this location!

- Before drilling or cutting holes, use a utility knife to remove unwanted fabric or vinyl, to keep material from snagging in a drill bit or saw.
- For door installations, check the clearance with the windows throughout the range of the window's travel, and verify that a mounted speaker will not interfere with the window crank or power window mechanism.
- If mounting speakers elsewhere, check for clearance around rear deck torsion bars, glove box, or other structural elements.
- Do not mount speakers where they will get wet.

## INSTALLATION

Figure 1.  
Mounting the 5000cs woofer with the grille.

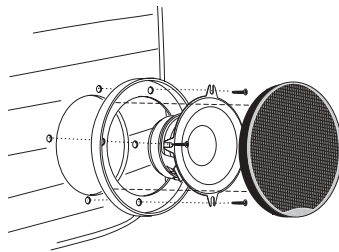

## INSTALLATION

Figure 2.  
Mounting the 6000cs woofer with the grille.

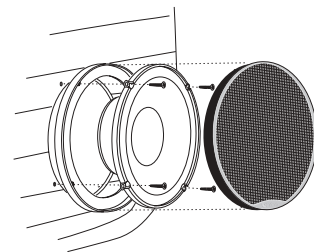

**NOTE:** The 6800cs is designed to replace speakers installed behind existing vehicle grilles, and does not include grilles. If you are mounting the 6800cs woofer in a 6" x 8" location, use the supplied adapter. The adapter is not required in 5" x 7" applications.

## INSTALLATION

Figure 3.  
Mounting the 6000cs woofer in standard speaker locations.

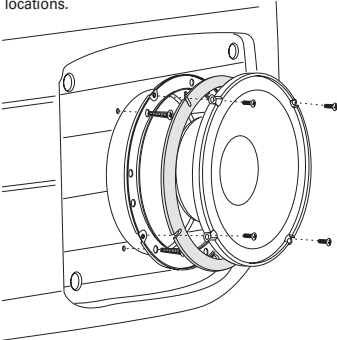

*Note: The 6000cs uses an adapter to fit standard 6" openings. Secure the adapter ring to the vehicle using the sheet-metal screws provided, then attach the 6000cs woofer to the ring with the machine screws.*

Figure 4.  
Mounting the 6000cs in 165mm speaker locations.

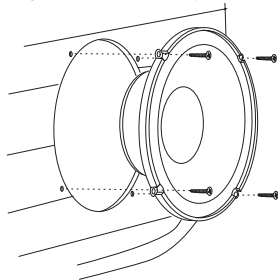

## INSTALLATION

Figure 5A.  
Mounting the tweeter using the I-Mount™ (patent no. 5,859,917) flush-mounting kit.

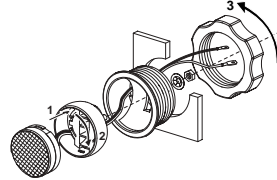

*Note: Aim the tweeter at the listening position by sliding the stud in the groove on the back of the tweeter cup and rotating the entire assembly in the mounting surface. Lock the tweeter in place, using the small retaining nut and the large plastic mounting nut.*

Figure 5B.

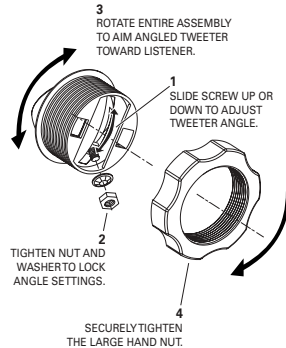

## INSTALLATION

Figure 6.  
Mounting the tweeter using the surface-mounting kit.

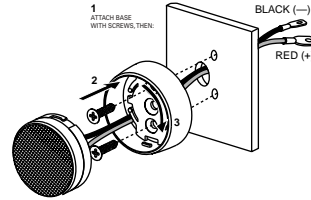

## CONNECTIONS

Connect the speakers to the crossover and the crossover to the amplifier, observing proper polarity.

Figure 7A.

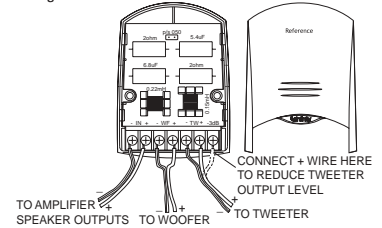
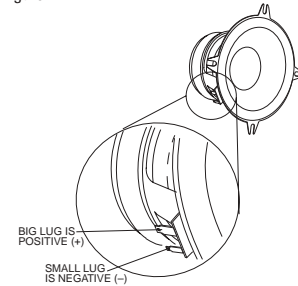

Figure 7B.



## SPECIFICATIONS

### 5000cs

Type: 5-1/4" 2-Way Component System  
Speaker Impedance: 4 Ohms  
Power Handling: 75W RMS, 225W Peak  
Frequency Response: 67Hz – 21kHz  
Sensitivity (2.83V, 1m): 92dB  
Crossover Frequency: 3.5kHz  
Mounting Depth: Woofer: 2-1/4" (58mm)  
Tweeter: 1-1/4" (32mm)  
Cut-out Diameter: Woofer: 4-11/16" (120mm)  
Tweeter: 1-13/16" (47mm)

### 6000cs

Type: 6-1/2" 2-Way Component System  
Speaker Impedance: 4 Ohms  
Power Handling: 90W RMS, 270W Peak  
Frequency Response: 53Hz – 21kHz  
Sensitivity (2.83V, 1m): 92dB  
Crossover Frequency: 3.5kHz  
Mounting Depth: Woofer: 2-1/16" (53mm)  
Tweeter: 1-1/4" (32mm)  
Cut-out Diameter: Woofer: 5" (127mm)  
Tweeter: 1-13/16" (47mm)

### 6800cs

Type: 6" x 8"5" x 7" 2-Way Component System  
Speaker Impedance: 4 Ohms  
Power Handling: 90W RMS, 270W Peak  
Frequency Response: 49Hz – 21kHz  
Sensitivity (2.83V, 1m): 92dB  
Crossover Frequency: 3.5kHz  
Mounting Depth: Woofer: 2-7/16" (62mm)  
Tweeter: 1-1/4" (32mm)  
Cut-out Diameter: Woofer: 5" x 7-1/4" (127mm x 185mm)  
Tweeter: 1-13/16" (47mm)

**A valid serial number is required for warranty coverage.**

Features, specifications and appearance are subject to change without notice.



TECHNOLOGY • PERFORMANCE • DESIGN

Infinity Systems • 250 Crossways Park Drive, Woodbury, NY 11797 USA  
800.553.3332 • FAX 516.682.3523 • www.infinitysystems.com  
© 2002 Harman International Industries, Incorporated • Part No.: REFCOSM • Printed 12/02  
A Harman International Company

### Declaration of Conformity



We, Harman Consumer International  
2, route de Tours  
72500 Chateau-du-Loir  
France

declare in own responsibility, that the products  
described in this owner's manual are in compliance  
with technical standards:

EN 50081-1:1992  
EN 50082-1:1997

Emmanuel Millot  
Harman Consumer International  
Chateau-du-Loir, France. 12/02